

16th July 2025

Long Stratton Bypass – Revised dates for bypass tie-ins, overnight works & closure of the A140

Dear neighbour, we are writing to inform you of revised dates for the upcoming overnight and weekend road closures on the A140 in July and August 2025. The dates and information included in this letter supersede any previous communication regarding these closures.

We thank you in advance for your patience and cooperation whilst we complete these necessary works. If you have any queries in the meantime, please do not hesitate to get in contact using the details at the top of this letter.

Kind Regards,
A140 Long Stratton Bypass Team

Overnight Closure 1: North tie-in

A section of Norwich Road (A140) between Brands Lane and Walnut Tree Cottage is scheduled to be completely closed to traffic from **20:00pm on Friday 25th July** and re-opened for daytime peak traffic hours by **06:00am Saturday 26th July**.

Weekend Closure 2: North tie-in

A closure in the same location will then be reinstated from **20:00pm on Friday 1st August** and lifted by **06:00am on Monday 4th August**.

These closures will facilitate overnight works to the north roundabout tie-in and the approach carriageway which will connect the existing Norwich Road (A140) to the main bypass. Marshalled access to properties will be maintained between the St Michael's Road junction and the construction area, as well as between the Brands Lane junction and the construction area. There will be no through route permitted through the construction area.

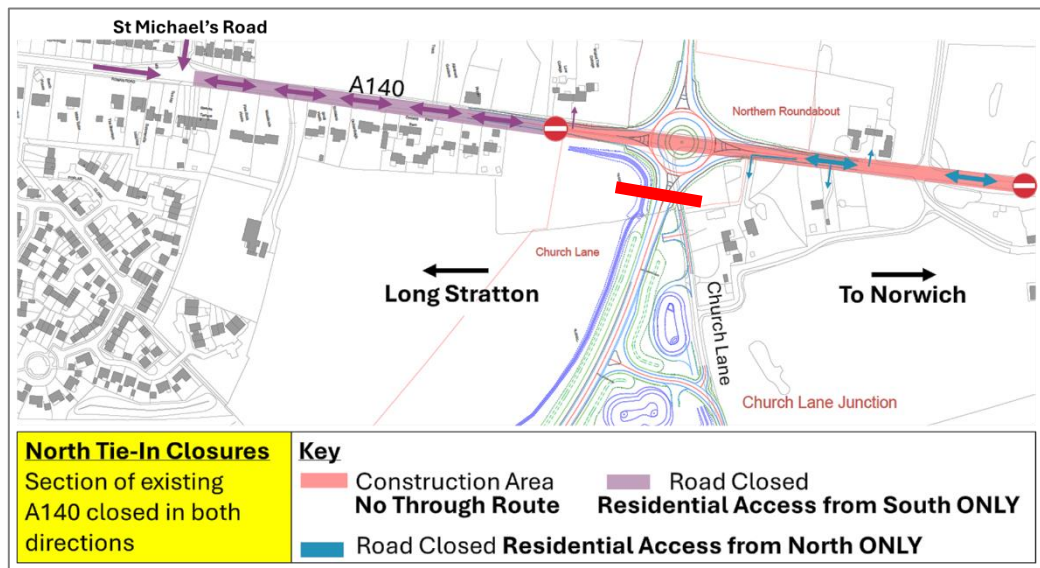

Figure 1: A drawing showing the location of the north tie-in closures and local access route.

From **06:00am on Monday 4th August**, both the east and west sides of the roundabouts will open to northbound and southbound traffic. The east exit for the main bypass carriageway will remain closed.

Overnight Closure 3: South tie-in

A section of Ipswich Road (A140) between the Wood Lane Junction and the Octavius South Site Compound is scheduled to be completely closed to traffic from **20:00pm on Thursday 7th August** and re-opened for daytime peak traffic hours by **06:00am Friday 8th August**.

Weekend Closure 4: South tie-in

A closure in the same location will then be reinstated from **20:00pm on Friday 8th August** and lifted by **06:00am on Monday 11th August**.

These closures will facilitate overnight works to the southern tie-in and the approach carriageway which will connect the existing Ipswich Road (A140) to the main bypass. Marshallled access to properties will be maintained between the Wood Lane junction and the construction area, as well as between the entrance to Octavius South Site Compound and the construction area. There will be no through route permitted through the construction area.

Figure 2: A drawing showing the location of the south tie-in closures and local access route.

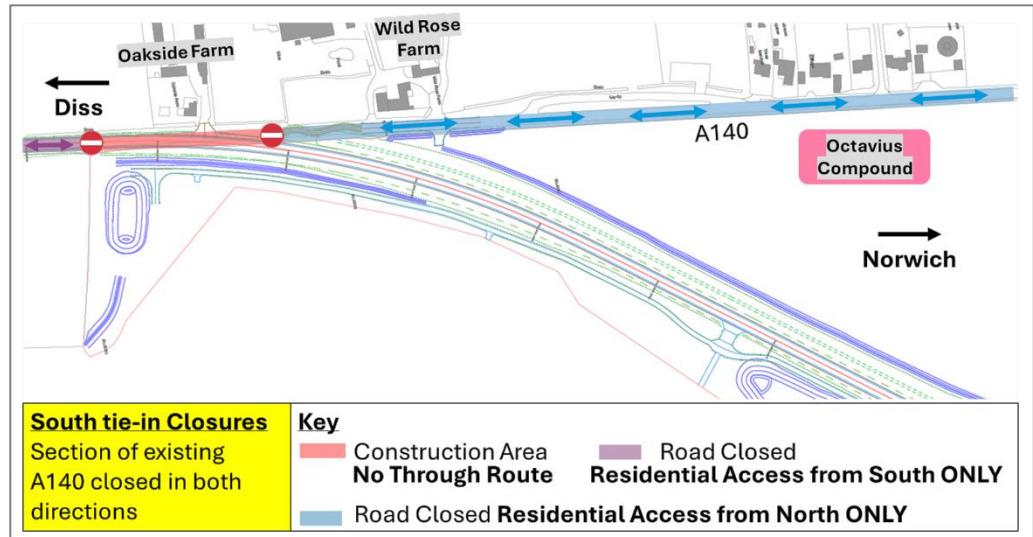

During these closures, the signed diversion route, which must follow the same classification of road as the road being closed, will divert traffic to utilise the A143 and A146.

New Alignment and Parkers Lane Tie-in

From **06:00am on Monday 11th August**, northbound and southbound traffic will use the bypass carriageway from the north roundabout and south tie-in. For a duration of up to three weeks, a section of the A140 adjacent to the Parkers Lane Junction will be closed to complete the new junction alignment. There will be no access to Long Stratton via Parkers Lane. There will be temporary three-way lights erected at the south tie-in to safely manage traffic flow from Ipswich Road and the bypass.

